

4

3

2

1

REVISIONS				
ZONE	REV	DESCRIPTION	DATE	APPROVED
	A	PRODUCTION RELEASE	2/27/17	CR
	B	CHANGED WEAR BAND	2/05/20	BS
	C	CHANGED WEAR BAND	12/11/20	MG
	D	CHANGED O-RING WAS: 029-18-033 IS: 029-11-033	6/2/23	NL

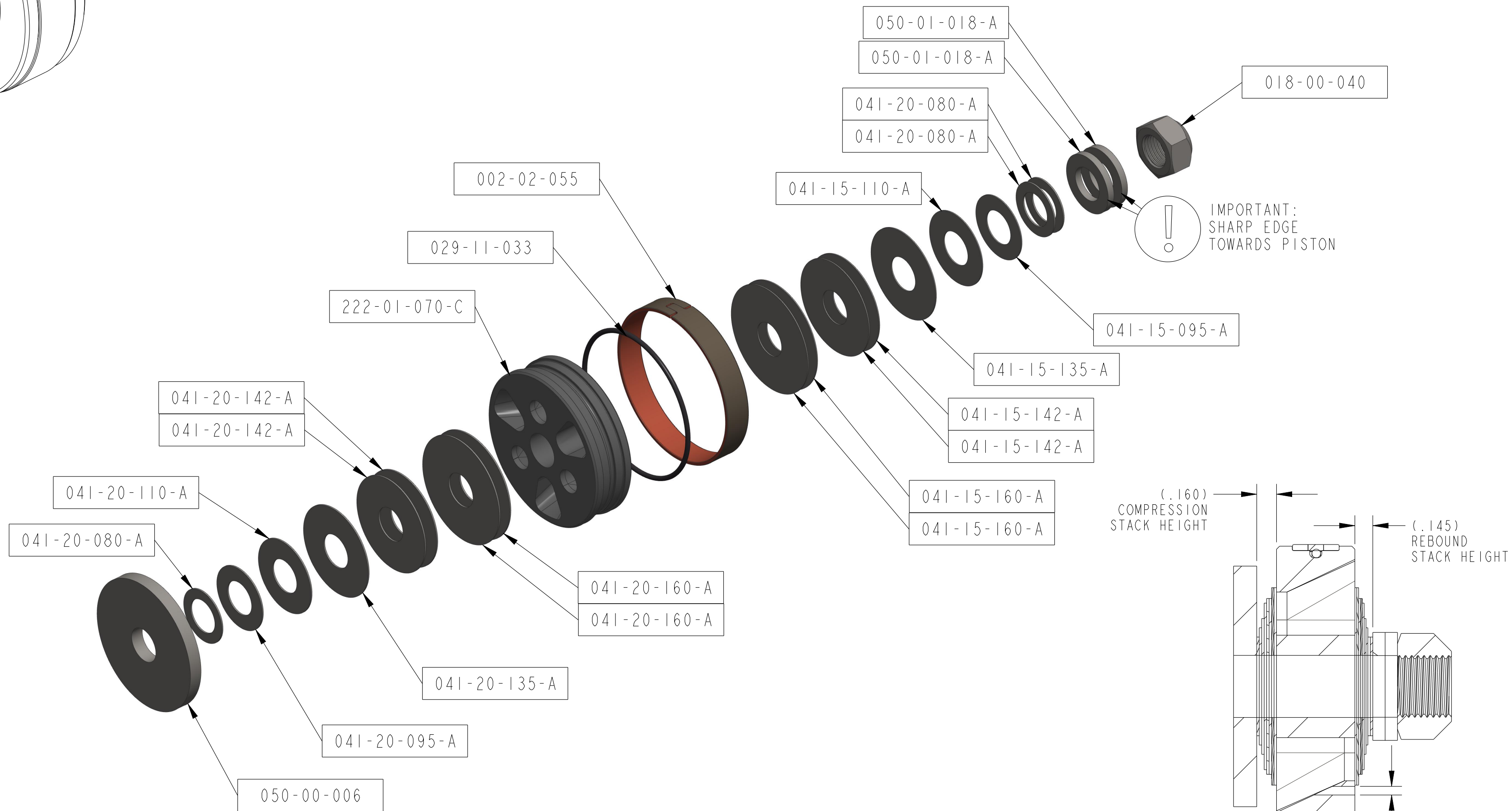
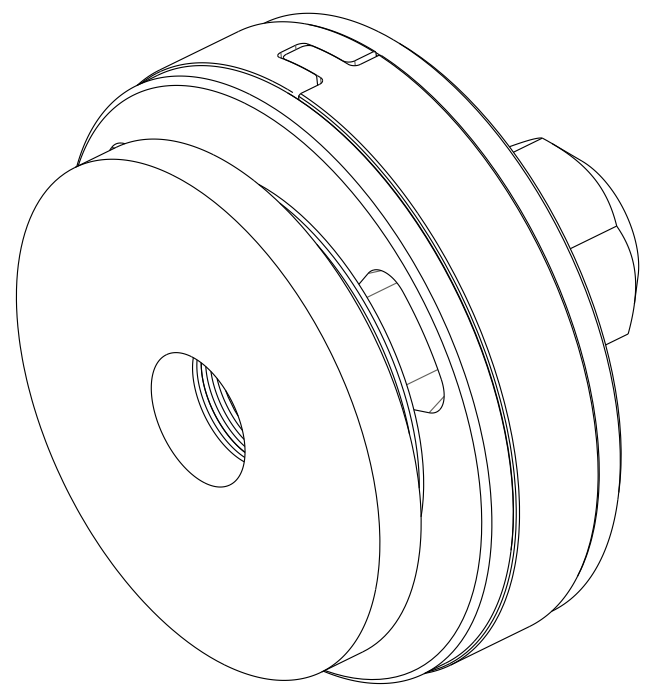

NOTES:  
1. FIRST APPLICATION: 2.5 BUMP STOP

- PROPRIETARY -  
THIS DOCUMENT CONTAINS CONFIDENTIAL, PROPRIETARY INFORMATION  
THAT IS FOX PROPERTY. DO NOT DISCLOSE TO OR DUPLICATE  
FOR OTHERS EXCEPT AS AUTHORIZED BY FOX.

UNLESS OTHERWISE SPECIFIED DIMENSIONS ARE IN: INCHES [MM]	PER ASME Y14.5M 1994	
	APPROVALS	DATE
	DWN. BY C RAHDERS	10/18/17
	CHK. BY	
TOLERANCES ARE: DECIMALS .XX [.X] ± .01 [0.25] .XXX [.XX] ± .005 [0.13]	ANGLES ± 1°	
THIRD ANGLE PROJECTION	ENG. C RAHDERS	10/18/17
DO NOT SCALE DRAWING	MFG.	
	ADD.	

**FOX** FOX Factory, Inc. Ph 831-768-1100  
130 Hangar Way, Watsonville, CA 95076 USA Fax 831-768-9312

TITLE  
Valving Assembly:  
2.5 Factory Series,  
Tuned Combination 322

SIZE DWG. NO.  
C 807-24-322

PLOT SCALE | .50:1 | SHEET 1 OF 2

4

3

2

ProE ASSEM

4

3

2

1

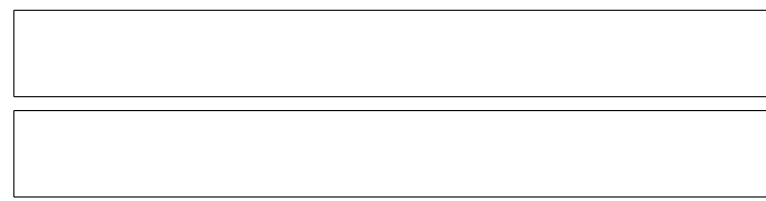
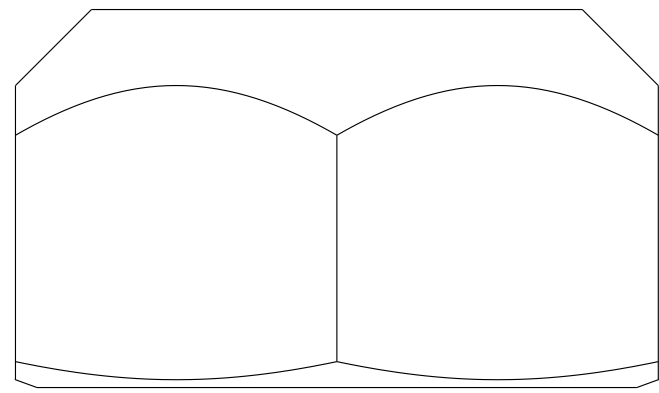

(2X) BACK UP WASHER

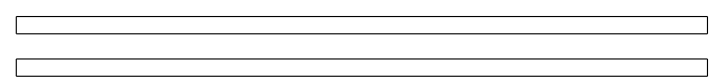

2X 0.800 X .020

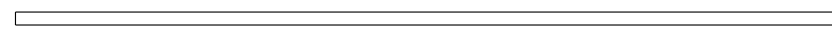

0.950 X .015

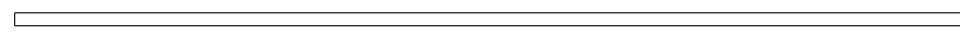

1.100 X .015

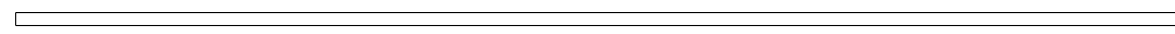

1.350 X .015

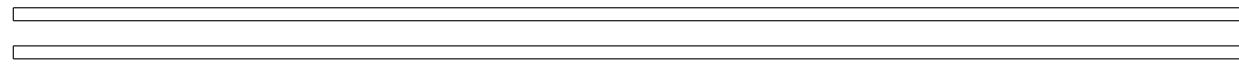

2X 1.425 X .015

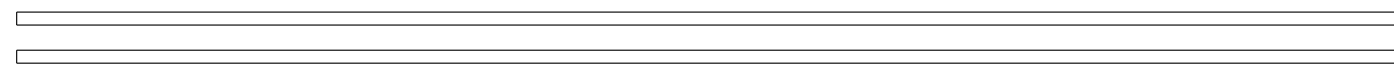

2X 1.600 X .015

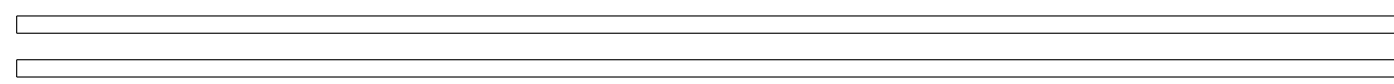
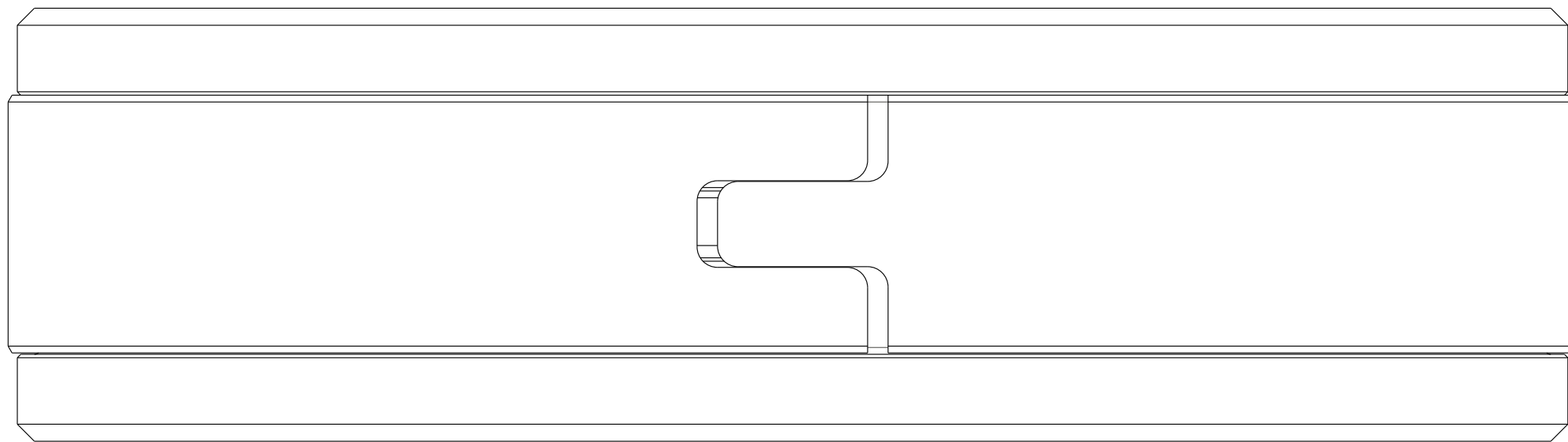

2X 1.600 X .020

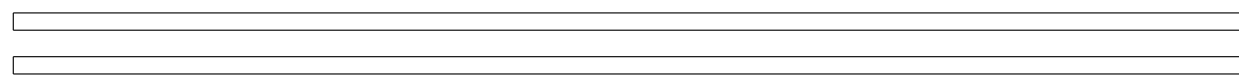

2X 1.425 X .020

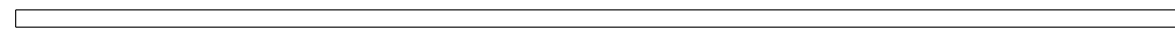

1.350 X .020

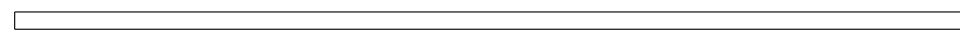

1.100 X .020



0.950 X .020

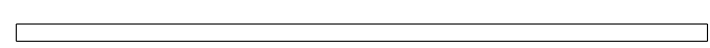

0.800 X .020

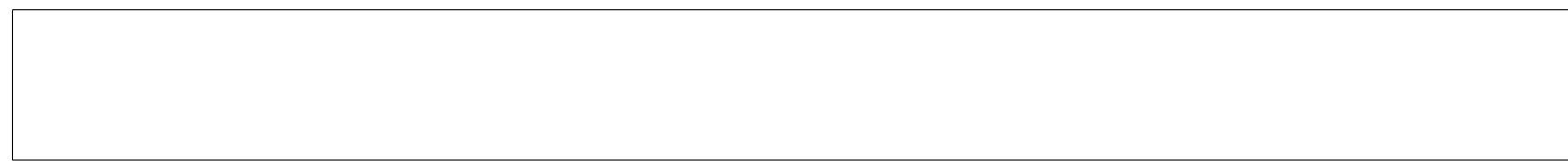

TOP OUT WASHER

D

D

C

C

B

B

A

A

- PROPRIETARY -  
 THIS DOCUMENT CONTAINS CONFIDENTIAL, PROPRIETARY INFORMATION  
 THAT IS FOX PROPERTY. DO NOT DISCLOSE TO OR DUPLICATE  
 FOR OTHERS EXCEPT AS AUTHORIZED BY FOX.

SIZE C	DWG. NO. <b>807-24-322</b>	REV. B
PLOT SCALE 1.50:1 SHEET		2 OF 2

4

3

2

1