

4

3

2

1

REVISIONS				
ZONE	REV	DESCRIPTION	DATE	APPROVED
	A	PRODUCTION RELEASE	11/09/16	EK/BS

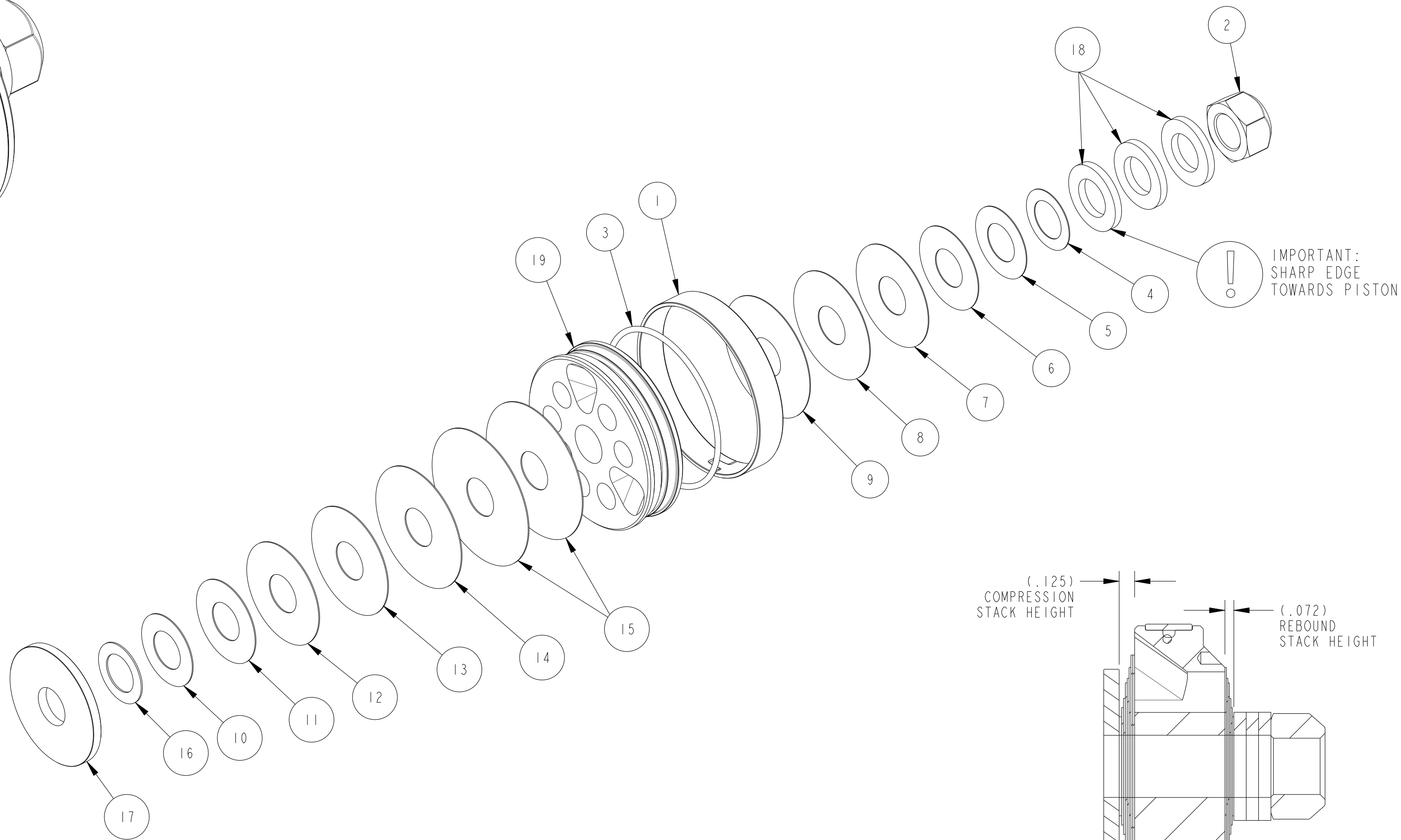
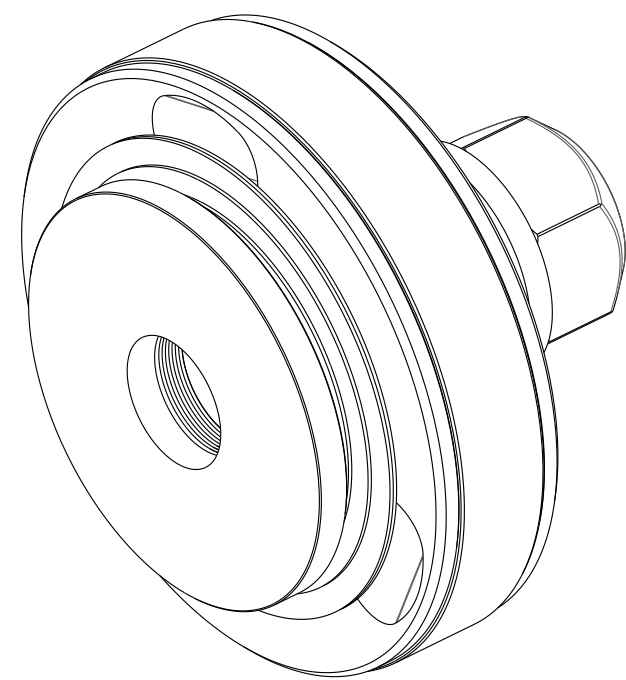

ITEM	PART NUMBER	QTY
1	002-02-055	1
2	018-00-040	1
3	029-18-033	1
4	041-12-080	1
5	041-12-095	1
6	041-12-110	1
7	041-12-135	1
8	041-12-142	1
9	041-12-160	1
10	041-15-095	1
11	041-15-110	1
12	041-15-135	1
13	041-15-142	1
14	041-15-160	1
15	041-15-180	2
16	041-20-080	1
17	050-00-001	1
18	050-01-018	3
19	222-01-291	1

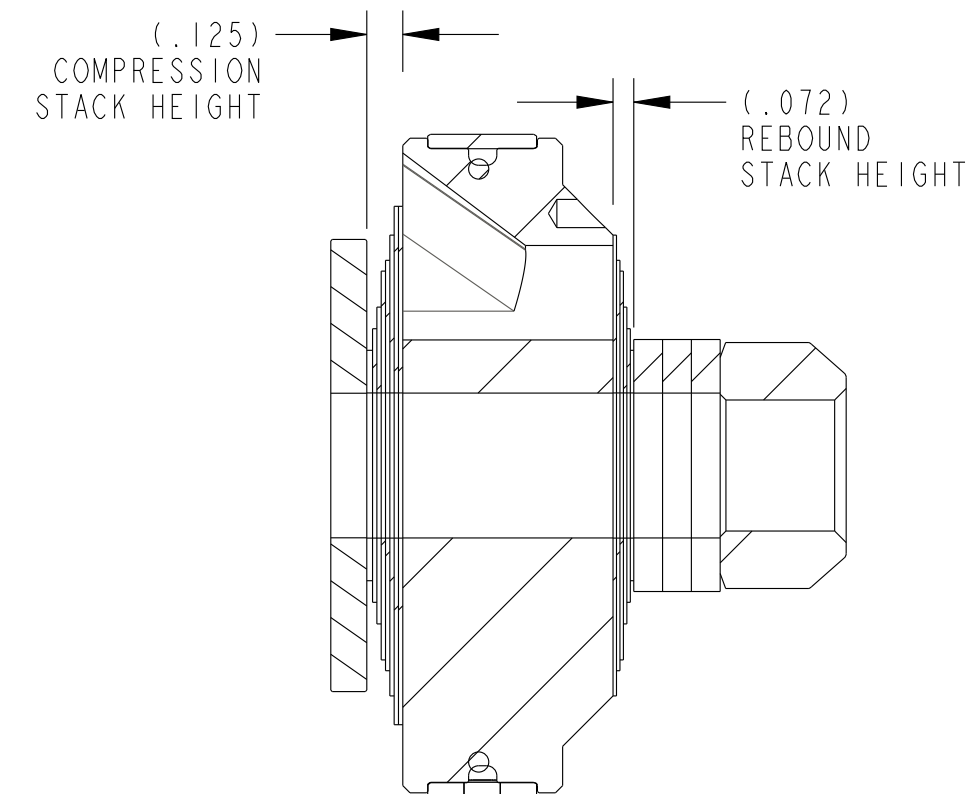

NOTES:

- REFERENCE: 2,1/70 (1X ϕ .052 BLEED)
- FIRST APPLICATION: 2.5 FRS EXTERNAL BYPASS 7/8" SHAFT

- PROPRIETARY -
THIS DOCUMENT CONTAINS CONFIDENTIAL, PROPRIETARY INFORMATION
THAT IS FOX PROPERTY. DO NOT DISCLOSE TO OR DUPLICATE
FOR OTHERS EXCEPT AS AUTHORIZED BY FOX.

UNLESS OTHERWISE SPECIFIED DIMENSIONS ARE IN: INCHES [MM] TOLERANCES ARE: DECIMALS .XX [.X] \pm .01 [0,25] ANGLES \pm 1° .XXX [.XX] \pm .005 [0,13] THIRD ANGLE PROJECTION DO NOT SCALE DRAWING	PER ASME Y14.5M 1994		FOX Factory, Inc. 130 Hangar Way, Watsonville, CA 95076 USA Ph 831-768-1100 Fax 831-768-9312	
	APPROVALS	DATE		TITLE
	DWN. BY E. KENYON	11/09/16		Valving Assembly: 2.5 Factory Series, Tuned Combination 303
	CHK. BY			
	ENG. B SMITH	11/09/16	SIZE DWG. NO.	
	MFG.		C 807-24-303	
	ADD.		PLOT SCALE .50:1	
			SHEET 1 OF 2	

4

3

2

4

3

2

1

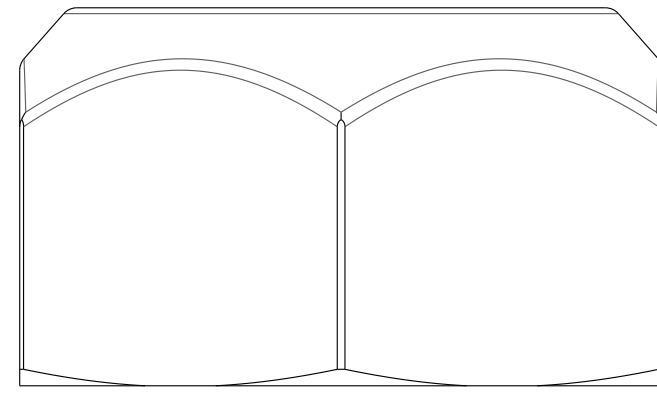

BACK UP WASHER



BACK UP WASHER



BACK UP WASHER

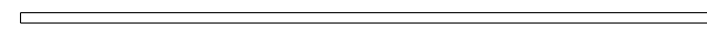

0.800 X .012

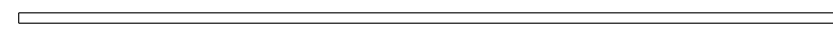

0.950 X .012

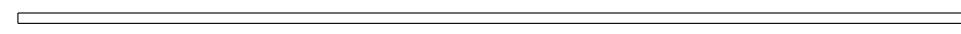

1.100 X .012

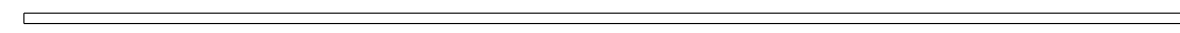

1.350 X .012

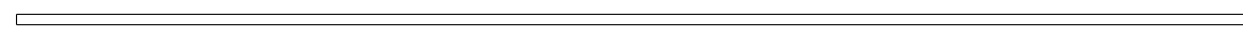

1.425 X .012

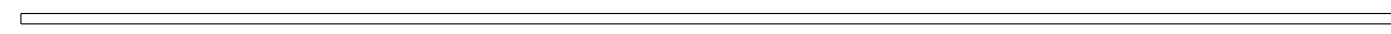

1.600 X .012

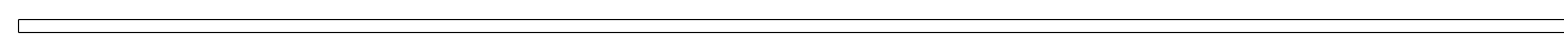
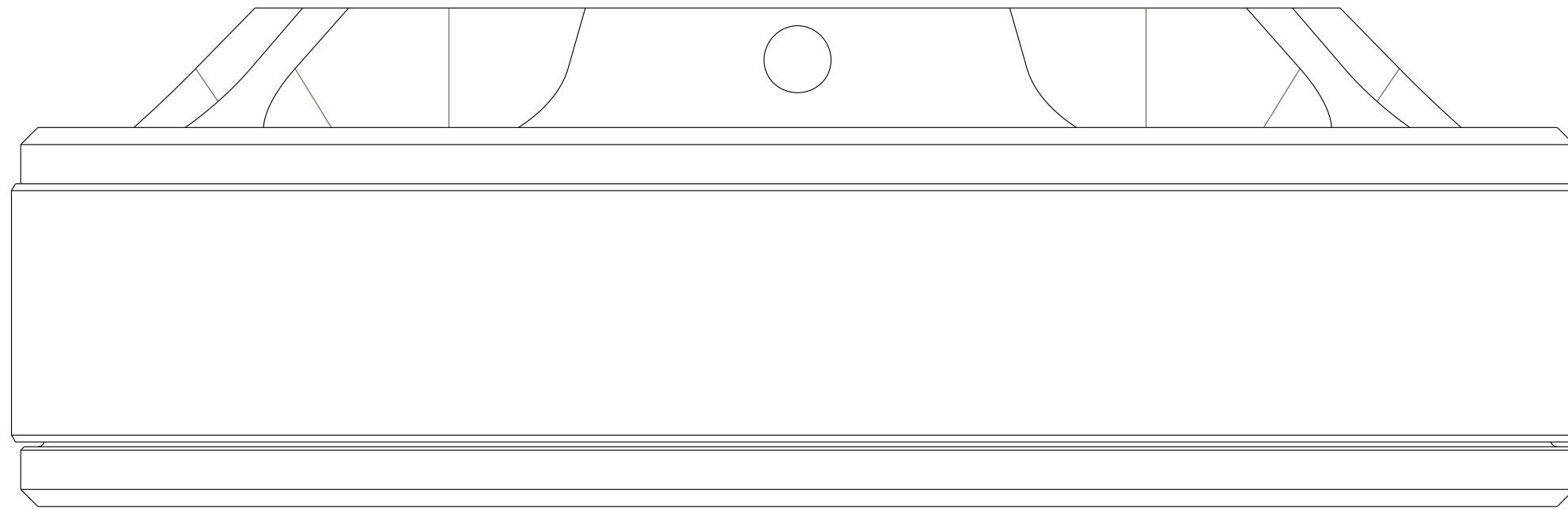

1.800 X .015

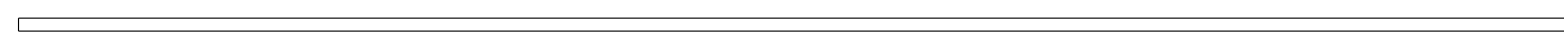

1.800 X .015



1.600 X .015



1.425 X .015



1.350 X .015



1.100 X .015



0.950 X .015



0.800 X .020

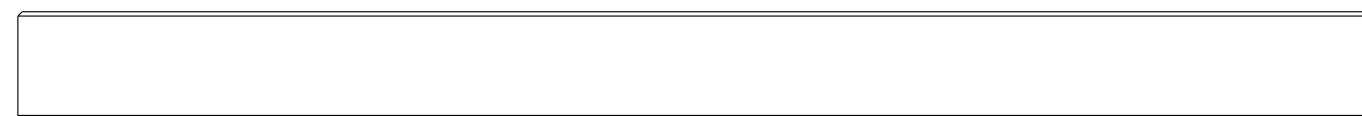

TOP OUT WASHER

- PROPRIETARY -
 THIS DOCUMENT CONTAINS CONFIDENTIAL, PROPRIETARY INFORMATION
 THAT IS FOX PROPERTY. DO NOT DISCLOSE TO OR DUPLICATE
 FOR OTHERS EXCEPT AS AUTHORIZED BY FOX.

SIZE C	DWG. NO. 807-24-303	REV.
PLOT SCALE 1.50:1 SHEET		2 OF 2

4

3

2

1

D

D

C

C

B

B

A

A